

THERMO-CRAFT ENGINEERING

www.thermocraftengineering.com



701 Western Avenue
Lynn, Massachusetts 01905

1 Centennial Dr.
Peabody, MA 01960

Phone: 1-781-599-4023



THERMO-CRAFT ENGINEERING

Thermo-Craft Engineering provides high quality products for numerous companies in the Military, Medical, Energy, Solar, Semiconductor, Food and Automotive Industries.

Services

Precision CNC Machining, Sheet Metal, Laser Cutting, Fabrication, Design & Contract Manufacturing

ISO 9001: 2015

Thermo-Craft Engineering's Mission

To provide high quality precision parts and services on time with added value while exceeding our customers expectations.



Thermo-Craft Engineering

THERMO-CRAFT ENGINEERING

Sheet Metal



- Punching – Utilizing Amada, Strippet and Muratec/Wiedemann (lights out) Turret Presses
- Press Brakes - Hydraulic Presses, and Manual Presses to 12 Feet
- CNC Tube Bending
- Roll Forming
- Assembly



Thermo-Craft Engineering

THERMO-CRAFT ENGINEERING

Laser Cutting



Laser Cutting
CO₂ Laser Marking
Fiber Laser Marking

Nitrogen cutting which eliminates carbon buildup on the part's edges rendering them paint ready.

Nesting software that maximizes material usage and minimizes cost.

Etching information such as part numbers, art or weld prep markings on a variety of materials including steel, plastic and wood. Maximum stock sheet size of 60" x 120".



Thermo-Craft Engineering

THERMO-CRAFT ENGINEERING

CNC Milling



Milling Capabilities

- 64" x 40" x 32"
- Full 4 Axis
- Coolant Thru Spindles
- Twin Pallet
- 16+ CNC Vertical & Horizontal Milling Centers



Thermo-Craft Engineering

THERMO-CRAFT ENGINEERING

CNC Turning



Turning Capabilities

- Up to 10" CNC Chuck
- Coolant Thru Spindles
- 20" Swing on CNC
- 28" Manual Swing
- 10+ CNC Turning Centers



Thermo-Craft Engineering

THERMO-CRAFT ENGINEERING

Welding and Fabrication



- AMS Certified Welding and Spot Welding per AWS D17.2.
- Complex Jigging Systems, Tool and Fixture Building
- Robotic Welding
- Pressure Testing, Leak Testing, Certified Brazing, Special Processes

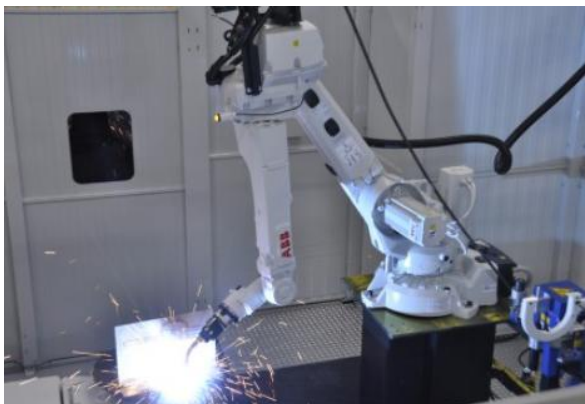

Thermo-Craft Engineering

THERMO-CRAFT ENGINEERING

Electro-Mechanical Assemblies



- Blueprints, diagrams, engineering specifications, bills of materials, written instructions or procedures to accurately assemble
- Soldering, and Wiring
- Maintain inventory of products
- Perform quality checks to insure the product meets quality standards
- Rework and/or repair assembled equipment and products according to engineering specification changes
- Perform all work in accordance with quality standards and established safety procedures
- Maintain a clean and safe work area



Thermo-Craft Engineering

THERMO-CRAFT ENGINEERING

Engineering services in Automation and Design

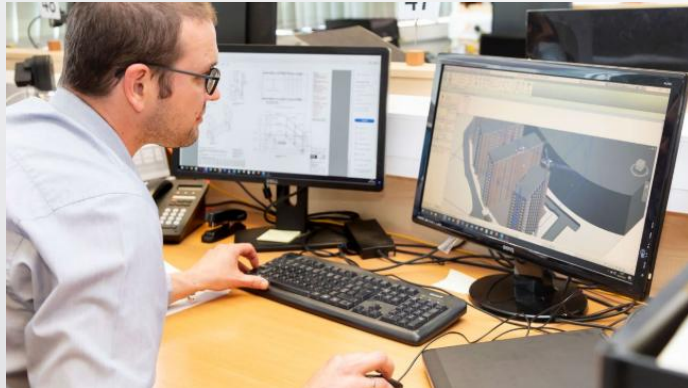

- Power Systems Design and Integration
- Motor Application
 - AC/DC, Stepper and Servo motors
 - Linear Motors Design
 - Hydraulics
- Rotary and linear positioning systems
- Automation Equipment and Design
- Heavy Electro-Mechanical System Design
- Robotic arm Programming and other Application

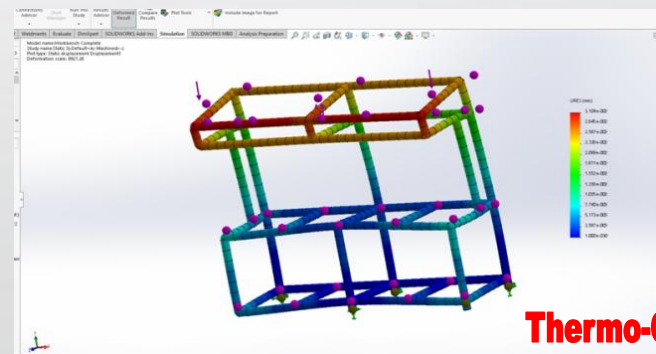
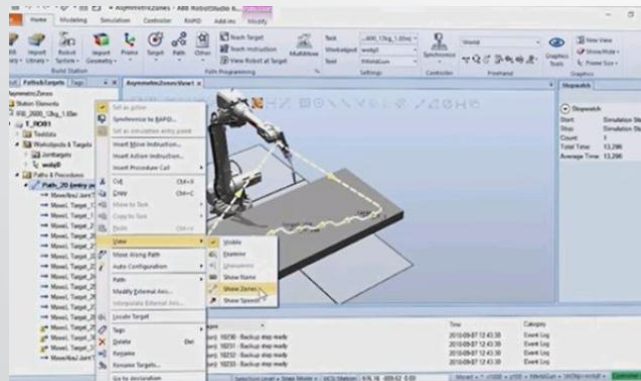

Thermo-Craft Engineering



- 86,000 Sq. Ft. State of the Art Manufacturing Facilities in Peabody & Lynn Massachusetts
- 67+ Employees
- Dedicated and experienced personnel in the manufacturing of high quality precision products, Fabrications, and services
- Engineering services in Automation and Design
- Design For Manufacturing services available for Machine parts, Sheet Metal parts, Weldment, and Electro Mechanical Assemblies
- Software: Solidworks, MasterCam, .dxf, iges file formats.
- Consulting services with over 100 years combined experience in supply chain and vendor management



Quality Management System

ISO 9001:2015

- Implementing compliance to AS9100 and ISO 13485 for registration
- Continuing with our TQM, Lean Manufacturing, Six Sigma and 5S procedures.



Hereby declares that

Thermo-Craft Engineering Corporation

**701 Western Ave
Lynn, MA 01905**

**1 Centennial Drive
Peabody, MA 01960**

has successfully applied a quality system for the
**Fabrication of complex brazements, machining components,
and large frame weldments for diversified customer base
including Aerospace and Defense, Semiconductor, Medical
and Solar Equipment.**

An on-site audit was performed and documented that the requirements of

ISO 9001: 2015

are fulfilled.

Certificate No. 17-1019

The certificate is valid from
December 1, 2017

The certificate is valid until
November 30, 2020

Michael Hopkins
Principal



Date of issue: December 1, 2017



Quality Measurement

- Brown & Sharpe CMM Machine
- Romar Absolute Arm – V3 Robotic
- Deltronic Optical Comparator
- Fully calibrated measurement devices

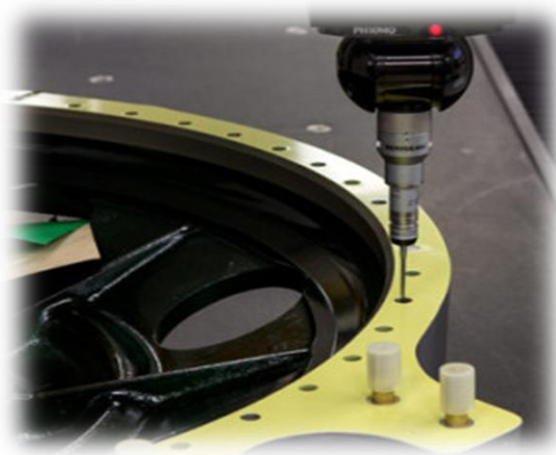

ISO 9001 : 2015
ITAR REGISTERED
AWS D17.1, CLASS A, B, C
D1.1, D1.2, D1.3, AND D1.6
WS 33739
AWS B2.2/AWS C3.4
NASA 8739.4
GIDEP REGISTERED
AWS D17.2, SPOT WELDING

DEFENSE



AEROSPACE

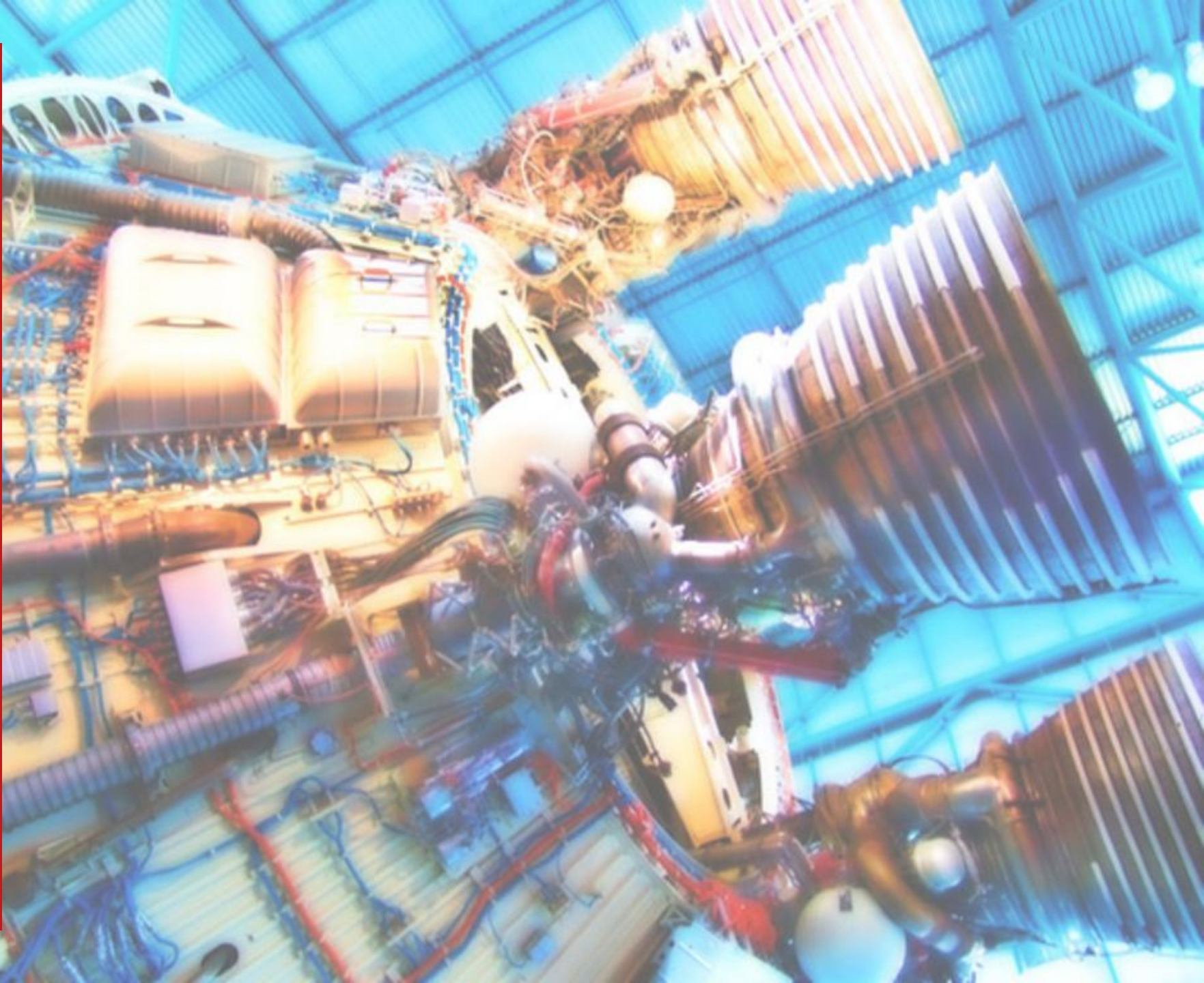

FOOD & BEVERAGE INDUSTRIES



ENERGY, SOLAR, SEMICONDUCTOR INDUSTRIES & More



Thermo-Craft Engineering Corp.

One Centennial Drive
Peabody, Mass. 01960

&

701 Western Ave.
Lynn, Mass. 01905

781-599-4023

b.vieno@thermocraftengineering.com

ISO 9001 : 2015

ITAR REGISTERED

AWS D17.1, CLASS A, B, C
D1.1, D1.2, D1.3, AND D1.6

WS 33739

AWS B2.2/AWS C3.4

NASA 8739.4

GIDEP REGISTERED

AWS D17.2, SPOT WELDING





THANK YOU